



FAG

## SES214-L

Plummer block housing

Schaeffler ID:  
0956144940000

Split plummer block housing for various bearing designs. The SNV series will be replaced by the new SES series in 2022.

## Technical information

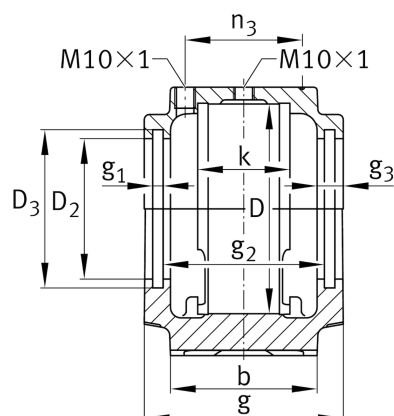
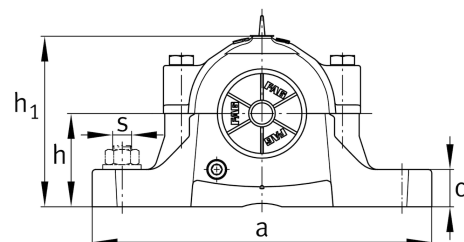
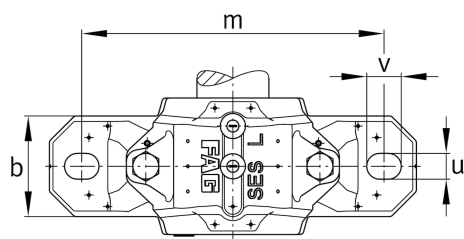

## Main Dimensions &amp; Performance Data

D	125 mm	Outside diameter bearing
a	275 mm	Length base
h <sub>1</sub>	158 mm	Height
g	105 mm	Width housing body
K	39 mm	Width bearing seat
	6,3 kg	Weight

## Dimensions

b	80 mm	Width base
c	30 mm	Height base
h	80 mm	Base to shaft centerline height
m	230 mm	Distance fixing bore
s	15,875 mm	Screw size
s	M16	Size of fixing screws
u	18 mm	Width slot
v	24 mm	Length slot
D <sub>2</sub>	112 mm	Diameter sealing
D <sub>3</sub>	120,5 mm	Diameter sealing groove
D <sub>5</sub>	118,2 mm	Outside diameter sealing labyrinth
g <sub>1</sub>	5 mm	Width sealing groove
g <sub>2</sub>	84,5 mm	Distance sealing
g <sub>3</sub>	15 mm	Wall thickness
g <sub>4</sub>	45 mm	Distance oil lubrication
m <sub>1</sub>	190 mm	Distance holes aligned pins m1
n <sub>3</sub>	57 mm	Distance lubrication
n <sub>4</sub>	90 mm	Distance lubrication sealing
u <sub>1</sub>	4 mm	Bore diameter u1
u <sub>2</sub>	14 mm	Bore diameter u2

